

# SURE<sup>®</sup> Cleaner Disinfectant

Concentrated cleaner disinfectant

## Description

SURE Cleaner Disinfectant is part of a unique range of plant based, 100% biodegradable professional cleaning products for all daily cleaning needs. SURE Cleaner Disinfectant is a concentrated detergent disinfectant for cleaning and disinfection of all surfaces in food premises.

## Key properties

- Suitable for cleaning and disinfecting of various water resistant surfaces in food premises
- Suitable for regular use
- Effective in all water conditions
- No fragrance nor dye, natural odour present due to plant based ingredients
- Contains plant based ingredients from renewable sources
- 100% biodegradable and decomposed by natural processes
- No environmental hazard classifications, no safety warnings for product in use for user

## Benefits

- Very effective against a wide range of micro-organisms, helps to improve hygiene security
- Bactericidal and yeasticidal activities
- Reduced environmental impact

## Use instructions

### Spray cleaning and disinfection:

1. Fill the 750ml spray bottle with water and dose 10ml SURE Cleaner Disinfectant to it.
2. Remove debris before applying product.
3. Spray surface with solution and clean with cloth or brush.
4. Re-apply solution and leave for 30 seconds.
5. Rinse thoroughly with clean water and allow to air dry.

### Bucket cleaning:

1. Dose 10ml SURE Cleaner Disinfectant per liter of hand warm water in a bucket (concentration of 1%).
2. Remove debris before applying product.
3. Apply solution and clean with cloth or brush.
4. Re-apply solution and leave for 30 seconds.
5. Rinse thoroughly with clean water and allow to air dry.

### Spray cleaning through a J2000 dosing system:

1. Make sure that the room where the product will be applied is well ventilated.
2. Remove debris before applying product.
3. Spray surface with solution (max 40°C) for maximum 5 minutes if sprayed continuously. (It is normal that an acid smell is experienced during application of the solution). Clean with cloth or brush.
4. Leave for 5 minutes.
5. Rinse thoroughly with clean water and allow to air dry.





# SURE<sup>®</sup> Cleaner Disinfectant

Concentrated cleaner disinfectant

## Technical data

Appearance	pale yellow liquid
pH neat	2
Relative density (20°C)	1.08
Viscosity (20°C)	<50 mPa.s

These figures are typical values and should not be interpreted as specifications.

## Safe handling and storage information

Full guidance on the handling and disposal of this product is provided in a separate Safety Data Sheet.

Only for professional users / specialists.

Store in original closed containers away from extremes of temperature.

## Product compatibility

Under recommended conditions of use, SURE Cleaner Disinfectant is suitable for use on all water resistant materials commonly encountered in the kitchens.

## Microbiological data

SURE Cleaner Disinfectant meets all European standards for making bactericidal and yeasticidal claims within 5 minutes.

SURE Cleaner Disinfectant passed the EN1276 (bacteria) at a dilution of 1% under dirty conditions in 5 minutes.

SURE Cleaner Disinfectant passed the EN1276 (bacteria) at a dilution of 1% under clean conditions in 30 seconds.

SURE Cleaner Disinfectant passed the EN13697 (both bacteria and yeast) at a dilution of 1% under dirty conditions in 5 minutes.

SURE Cleaner Disinfectant passed the EN1650 (yeast) at a dilution of 1% under dirty conditions in 5 minutes.

## Environmental information

\*SURE Cleaner Disinfectant is 100% biodegradable according to OECD 301B test.

## Available pack size

SURE Cleaner Disinfectant is available in 1L bottle and 5L can, both suitable for recycling. 5L packaging can be used to refill the 1L bottle for ease of use on daily basis.

# Mini Guide – SURE® Cleaner Disinfectant SmartDose™

Available in 1.4L SmartDose



SmartDose  
dispensing system

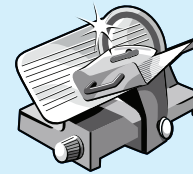

Cleans and disinfects  
in one step



Kills germs

Use for cleaning and  
disinfecting:

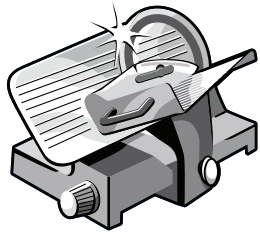

General kitchen equipment



Kitchen surfaces

Using...

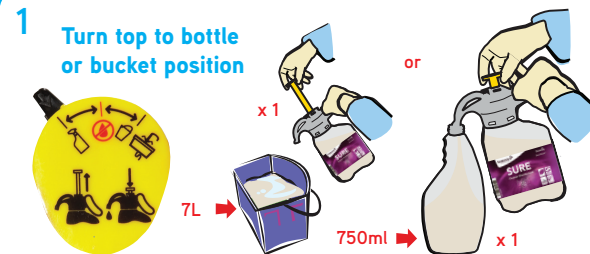

**Dose**  
Pull then push 1 x  
dose into 7 litres of  
hand hot water  
OR  
1 x dose into 750ml  
spray bottle.

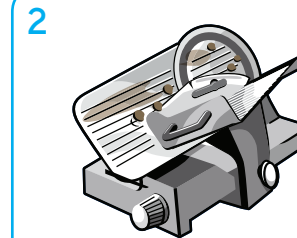

Remove debris before  
applying product.



Apply solution with  
cloth or spray.



Leave for 5 minutes.  
Rinse thoroughly  
and allow to air dry.